

These instructions are for use with 2007-2010 receivers only. 2011+ receivers cannot be customer programmed and are marked with a "2011" on their label. Please order RES-Remote-2011 from 3built.com and we will send you return shipping information for us to program the new remote for you.

INSTALLATION INSTRUCTIONS

WARNING

BY INSTALLING AND/OR USING THIS PRODUCT YOU AGREE TO OUR "END USER AGREEMENT". IT WAS INCLUDED WITH YOUR REMOTE ENGINE SHUT-OFF INSTALLATION INSTRUCTIONS AND AVAILABLE ON-LINE AT <http://www.3built.com/documents.asp>

OPENING THE RES(REMOTE ENGINE SHUT-OFF) RECEIVER ENCLOSURE MAY VOID YOUR RECEIVER WARRANTY IF THE RECEIVER IS NOT RE-SEALED PROPERLY.

You have the option to send in your existing RES to us for FREE RES-REMOTE programming. Please e-mail techsupport@3built.com for mailing information and an RMA#.

Use of this product could result in injuries to the rider due to the sudden loss of engine power. Motorcycles and ATV's may lose stability when engine power is disabled. Control of the vehicle will also be limited after engine is disabled. This product will not stop a vehicle. It will not apply the brakes or any other mechanism to reduce speed. It is designed to disable the engine by shutting off the ignition system. It functions similarly to the vehicle's stock (OEM) RUN/STOP switch. Use extreme caution as to when and where the vehicle is before disabling the engine. Proper judgment must be used when disabling engine power. Performance and range is not guaranteed. Radio frequency interference may be common in some areas. Use of motorcycles and ATV's is an inherently dangerous activity. Wear proper protective gear when operating the vehicle. If any doubt of potential injury, do not use. Once installed, to understand how this product functions, test the device by disabling the vehicle's engine, first at idle and then at low speed. This product's installation and

PROGRAMMING INSTRUCTIONS

- 1) Disconnect power to the RES by unplugging the receiver power connector.
- 2) Remove the four philips head screws holding the RES enclosure together (Fig. 1).

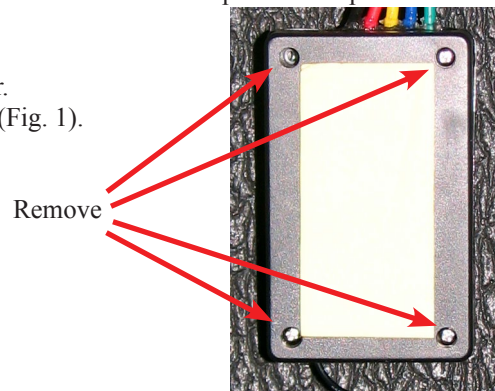

Fig. 1

- 3) Carefully open the enclosure to expose the circuit board. Take care not to damage the antenna wire.

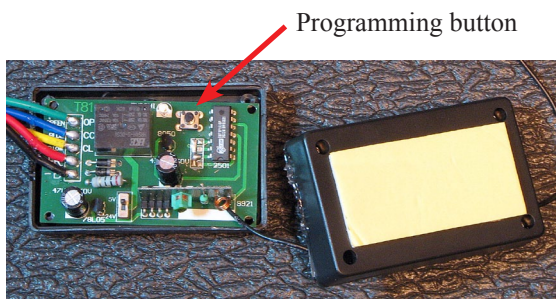

Fig. 2

2009 UPDATE
The programming button is now white instead of black.

- 4) You are now ready to program the new remote. Have the new remote handy and re-apply power to the RES by plugging in the receiver power connector.

5) The next few steps must be done together and within the stated time. Please read through the next few steps first to familiarize yourself with the procedure.

6) Press and Hold the programming button shown in Fig. 2. In approximately 6 seconds the LED with light red (Fig. 4).

Press Button &
Hold for 6 seconds

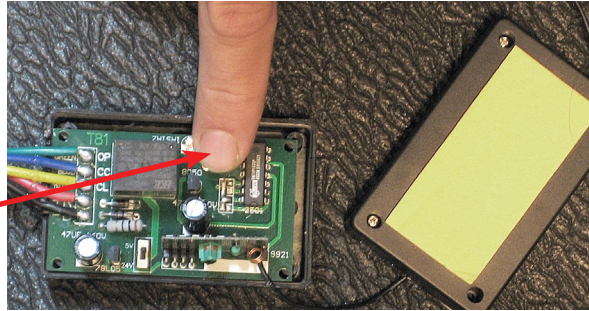

Fig. 3

2009 UPDATE

The programming LED as been replaced with a buzzer. Push and hold the programming button until a sound a heard, then push a button on the transmitter.

7) Within 3 seconds of the LED lighting, press the LOCK button on the remote (Fig. 5). The relay will click and the receiver is programmed to the new remote. The previous remote's code has not been erased and both remote will not operate the RES.

LED on

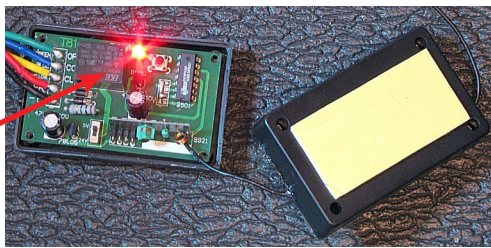

Fig. 4

2009 UPDATE

The programming LED as been replaced with a buzzer. Push and hold the programming button until a sound a heard, then push a button on the transmitter.

Press LOCK Button
within 3 seconds.

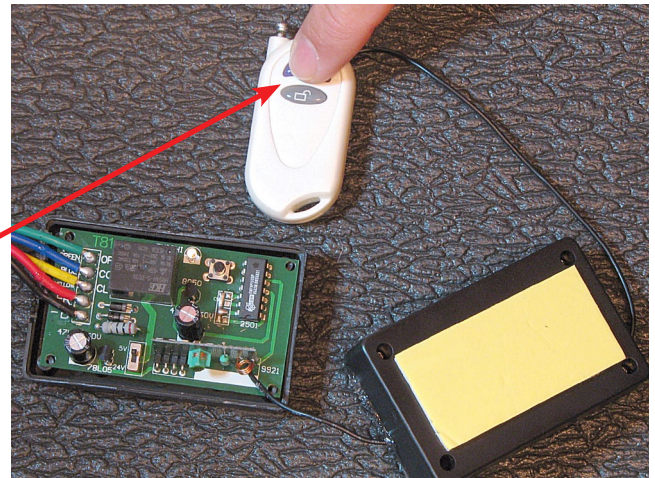

Fig. 5

8) If the LED does not light when pressing the power button, disconnect the power source to the RES for 5 seconds and reapply.

9) Use RTV Silicone to seal the RES enclosure again. Place silicone on sealing edges and wires. Make sure to seal around all wires.

10) Install the cover and the four screws that were removed in Step 2.

11) The silicone will take about 24 ours to cure properly. Once cured reinstall the RES receiver on to the vehicle.

Note:

To completely erase all programmed remote codes from the receiver's memory:

Apply power to the RES. Press and Hold the programming button (Fig. 2) for approximately 10 seconds. The RES's LED will flash rapidly three times to confirm that all codes have been erased.